

Technical Characteristics

Part Number

Han[®] 1A Kit

Hood	Top Entry
Housing	Snap-In Bulkhead
Material	Polyamide Plastic
Protection Degree	IP65
Temp Rating	-30 to +90C
Cable Gland	Plastic
Cable Diameter	5.7 – 10mm
Insert	3+GND
Screw Terminals	18-14AWG
Wire Strip Length	7.5mm
Mating Cycles	>100
Flammability	V-0

73 10 100 0016



Electrical Characteristics

Rated Current	10amps
Rated Voltage acc. UL	250V
Rated Impulse Voltage	6kV

Drawings and Assembly Information

Dimensions in mm

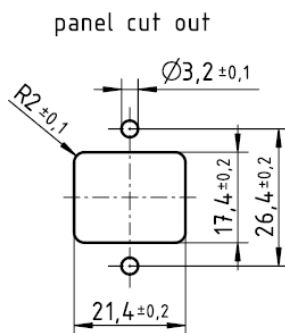
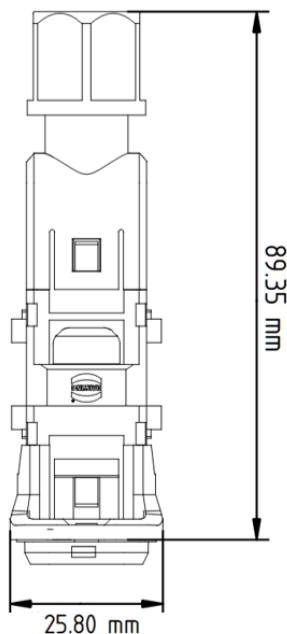

Tooling and Torque Values

Type	Tool	Torque (Nm)
Terminal Screws (M3)	Slotted 0.4 x 2.5	0.25
Mounting Screws (M3 recommended)	-	0.3
Recommended Punch Die	09990000973	-

Kit Contents

Male Insert	09 10 003 2601
Female insert	09 10 003 2701
Housing	09 10 000 0300
Hood & Gland	09 10 000 0400

Technical Characteristics

Part Number

Han[®] 1A Kit

Hood	Top Entry
Housing	Snap-In Coupler
Material	Polyamide Plastic
Protection Degree	IP65
Temp Rating	-30 to +90C
Cable Gland	Plastic
Cable Diameter	5.7 – 10mm
Insert	3+GND
Screw Terminals	18-14AWG
Wire Strip Length	7.5mm
Mating Cycles	>100
Flammability	V-0

73 10 100 0017



* Mounting Frame Included

Electrical Characteristics

Rated Current	10amps
Rated Voltage acc. UL	250V
Rated Impulse Voltage	6kV

Drawings and Assembly Information

Dimensions in mm

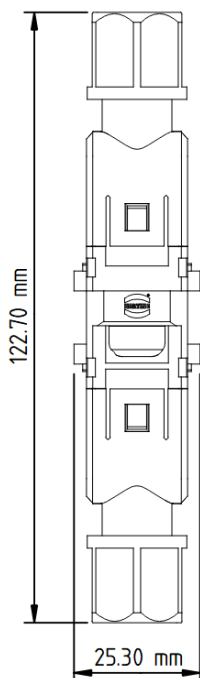

Tooling and Torque Values		
Type	Tool	Torque (Nm)
Terminal Screws (M3)	Slotted 0.4 x 2.5	0.25

Kit Contents	
Male Insert	09 10 003 2601
Female insert	09 10 003 2701
Hood & Gland (x2)	09 10 000 0400
Mounting Frame	09 10 000 9908

For further information, please reach out to techsupportUS@HARTING.com

Technical Characteristics

Part Number

Han[®] 1A Kit

Hood	Top Entry
Housing	Snap-In Angled Bulkhead
Material	Polyamide Plastic
Protection Degree	IP65
Temp Rating	-30 to +90C
Cable Gland	Plastic
Cable Diameter	5.7 – 10mm
Insert	3+GND
Screw Terminals	18-14AWG
Wire Strip Length	7.5mm
Mating Cycles	>100
Flammability	V-0

73 10 100 0018



Electrical Characteristics

Rated Current	10amps
Rated Voltage acc. UL	250V
Rated Impulse Voltage	6kV

Drawings and Assembly Information

Dimensions in mm

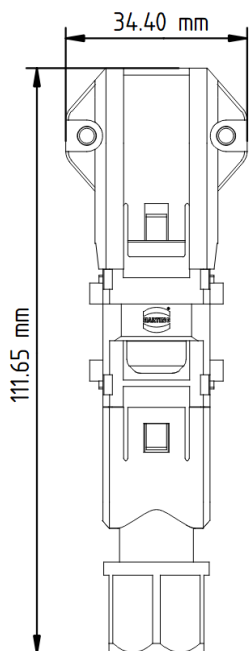

Tooling and Torque Values		
Type	Tool	Torque (Nm)
Terminal Screws (M3)	Slotted 0.4 x 2.5	0.25
Mounting Screws (M3 recommended)	-	0.3
Recommended Punch Die	09990000973	-

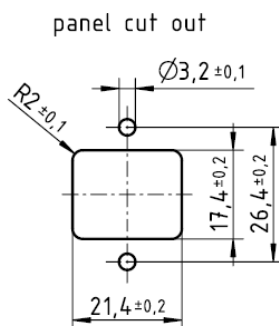

Kit Contents	
Male Insert	09 10 003 2601
Female insert	09 10 003 2701
Housing	09 10 000 0800
Hood & Gland	09 10 000 0400

For further information, please reach out to techsupportUS@HARTING.com

Technical Characteristics

Part Number

Han[®] 1A Kit

Hood	Top Entry
Housing	Snap-In Coupler
Material	Polyamide Plastic
Protection Degree	IP20
Temp Rating	-30 to +90C
Cable Gland	Plastic
Cable Diameter	5.7 – 10mm
Insert	3+GND
Screw Terminals	18-14AWG
Wire Strip Length	7.5mm
Mating Cycles	>100
Flammability	V-0

73 10 100 0019



* Zip tie for discrete wires or cable included

Electrical Characteristics

Rated Current	10amps
Rated Voltage acc. UL	250V
Rated Impulse Voltage	6kV

Drawings and Assembly Information

Dimensions in mm

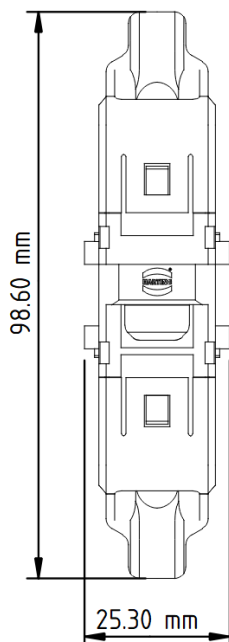

Tooling and Torque Values		
Type	Tool	Torque (Nm)
Terminal Screws (M3)	Slotted 0.4 x 2.5	0.25

Kit Contents	
Male Insert	09 10 003 2601
Female insert	09 10 003 2701
Hood (x2)	09 10 000 5300

Technical Characteristics

Part Number

Han[®] 1A Kit

Hood	Top Entry
Housing	Locking Lever Bulkhead
Material	Polyamide Plastic
Protection Degree	IP65
Temp Rating	-30 to +90C
Cable Gland	Plastic
Cable Diameter	5.7 – 10mm
Insert	3+GND
Screw Terminals	18-14AWG
Wire Strip Length	7.5mm
Mating Cycles	>100
Flammability	V-0

73 10 100 0020



Electrical Characteristics

Rated Current	10amps
Rated Voltage acc. UL	250V
Rated Impulse Voltage	6kV

Drawings and Assembly Information

Dimensions in mm

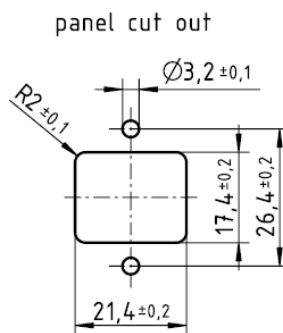
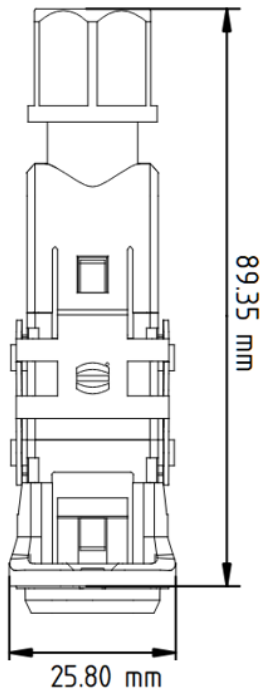

Tooling and Torque Values

Type	Tool	Torque (Nm)
Terminal Screws (M3)	Slotted 0.4 x 2.5	0.25
Mounting Screws (M3 recommended)	-	0.3
Recommended Punch Die	09990000973	-

Kit Contents

Male Insert	09 10 003 2606
Female insert	09 10 003 2706
Housing	09 10 000 0300
Hood & Gland	09 10 000 0400
Lever	09 10 000 5200

For further information, please reach out to techsupportUS@HARTING.com

Technical Characteristics

Part Number

Han[®] 1A Kit

Hood	Top Entry
Housing	Locking Lever Coupler
Material	Polyamide Plastic
Protection Degree	IP65
Temp Rating	-30 to +90C
Cable Gland	Plastic
Cable Diameter	5.7 – 10mm
Insert	3+GND
Screw Terminals	18-14AWG
Wire Strip Length	7.5mm
Mating Cycles	>100
Flammability	V-0

73 10 100 0021



* Mounting Frame Included

Electrical Characteristics

Rated Current	10amps
Rated Voltage acc. UL	250V
Rated Impulse Voltage	6kV

Drawings and Assembly Information

Dimensions in mm

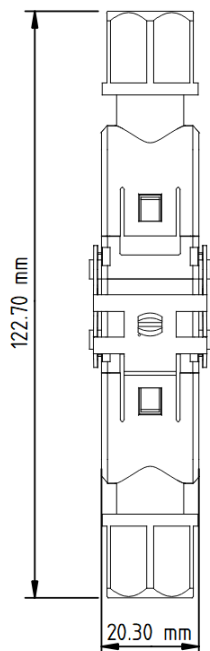

Tooling and Torque Values		
Type	Tool	Torque (Nm)
Terminal Screws (M3)	Slotted 0.4 x 2.5	0.25

Kit Contents	
Male Insert	09 10 003 2606
Female insert	09 10 003 2706
Hood & Gland (x2)	09 10 000 0400
Lever	09 10 000 5200
Mounting Frame	09 10 000 9908

For further information, please reach out to techsupportUS@HARTING.com

Technical Characteristics

Part Number

Han[®] 1A Kit

Hood	Top Entry
Housing	Locking Lever Angled Bulkhead
Material	Polyamide Plastic
Protection Degree	IP65
Temp Rating	-30 to +90C
Cable Gland	Plastic
Cable Diameter	5.7 – 10mm
Insert	3+GND
Screw Terminals	18-14AWG
Wire Strip Length	7.5mm
Mating Cycles	>100
Flammability	V-0

73 10 100 0022



Electrical Characteristics

Rated Current	10amps
Rated Voltage acc. UL	250V
Rated Impulse Voltage	6kV

Drawings and Assembly Information

Dimensions in mm

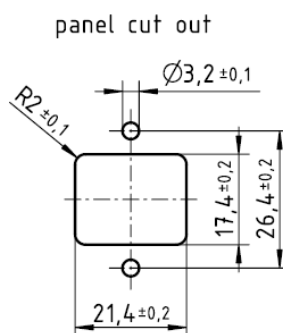
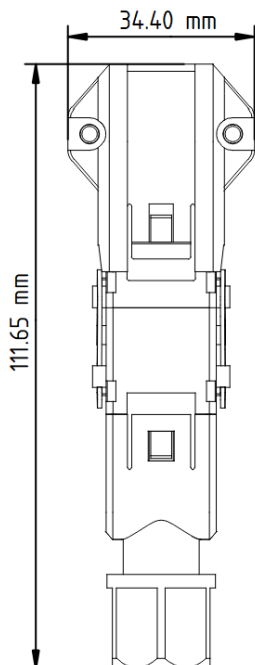

Tooling and Torque Values

Type	Tool	Torque (Nm)
Terminal Screws (M3)	Slotted 0.4 x 2.5	0.25
Mounting Screws (M3 recommended)	-	0.3
Recommended Punch Die	09990000973	-

Kit Contents

Male Insert	09 10 003 2606
Female insert	09 10 003 2706
Housing	09 10 000 0800
Hood & Gland	09 10 000 0400
Lever	09 10 000 5200

For further information, please reach out to techsupportUS@HARTING.com

Technical Characteristics

Part Number

Han[®] 1A Kit

Hood	Top Entry
Housing	Locking Lever Coupler
Material	Polyamide Plastic
Protection Degree	IP20
Temp Rating	-30 to +90C
Cable Gland	Plastic
Cable Diameter	5.7 – 10mm
Insert	3+GND
Screw Terminals	18-14AWG
Wire Strip Length	7.5mm
Mating Cycles	>100
Flammability	V-0

73 10 100 0023



Electrical Characteristics

Rated Current	10amps
Rated Voltage acc. UL	250V
Rated Impulse Voltage	6kV

* Zip tie for discrete wires or cable included

Drawings and Assembly Information

Dimensions in mm

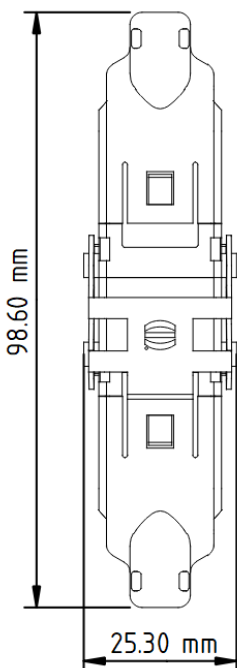

Tooling and Torque Values		
Type	Tool	Torque (Nm)
Terminal Screws (M3)	Slotted 0.4 x 2.5	0.25

Kit Contents	
Male Insert	09 10 003 2606
Female insert	09 10 003 2706
Hood & Gland (x2)	09 10 000 5300
Lever	09 10 000 5200